

# Appendix 1

**(Grand Union Company Ltd.)  
Units 1, 2 and 3  
Thomas More Square  
London  
E1W 1YN**

**Licensable Activities authorised by the licence**

The sale by retail of alcohol  
The provision of late night refreshment  
The provision of regulated entertainment

**See the attached licence for the licence conditions**

**Signed by**

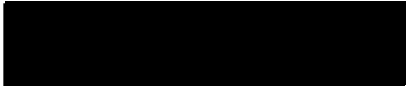
**John McCrohan**   
**Trading Standards and Licensing Manager**

**Date: 14<sup>th</sup> December 2015**



**Part A - Format of premises licence**

Premises licence number

19857

**Part 1 - Premises details**

**Postal address of premises, or if none, ordnance survey map reference or description**

(Grand Union Company Ltd.)  
Units 1, 2 and 3  
Thomas More Square

**Post town**

London

**Post code**

E1W 1YN

**Telephone number**

None

**Where the licence is time limited the dates**

Not applicable

**Licensable activities authorised by the licence**

- The sale by retail of alcohol
- The provision of late night refreshment
- The provision of regulated entertainment

### **The times the licence authorises the carrying out of licensable activities**

#### The supply of alcohol (both on and off sales)

- Monday to Wednesday from 11:00hrs to 00:00hrs (midnight)
- Thursday to Saturday from 11:00hrs to 01:00hrs (the following day)
- Sunday from 11:00hrs to 22:00hrs

#### The provision of late night refreshment (both indoors and outdoors)

- Monday to Saturday from 23:00hrs to 00:00hrs (midnight)

#### The provision of regulated entertainment in the form of live music (indoors)

- Monday to Saturday from 19:00hrs to 23:00hrs
- Sunday from 13:00hrs to 22:00hrs
- 

#### The provision of regulated entertainment in the form of recorded music (indoors)

- Monday to Wednesday from 07:00hrs to 00:00hrs (midnight)
- Thursday to Saturday from 07:00hrs to 01:00hrs (the following day)

#### The provision of regulated entertainment in the form of films (indoors)

- Monday to Saturday from 09:30hrs to 23:00hrs
- Sunday from 09:30hrs to 22:00hrs

### **The opening hours of the premises**

- Monday to Wednesday from 07:00hrs to 00:00hrs (midnight)
- Thursday to Saturday from 07:00hrs to 01:30hrs (the following day)
- Sunday 07:00hrs to 22:00hrs

### **Where the licence authorises supplies of alcohol whether these are on and/ or off supplies**

- On and off sales

## **Part 2**

**Name, (registered) address, telephone number and email (where relevant) of holder of premises licence**

Grand Union Company Ltd.  
111 Kennington Road  
London  
SE11 6SF

**Registered number of holder, for example company number, charity number (where applicable)**

Registered Company Number: 06671807

**Name, address and telephone number of designated premises supervisor where the premises licence authorises the supply of alcohol**

John Byrne

[REDACTED]

**Personal licence number and issuing authority of personal licence held by designated premises supervisor where the premises licence authorises for the supply of alcohol**

Licence Number: L [REDACTED]  
Issuing Authority: [REDACTED]

## Annex 1 - Mandatory conditions

No supply of alcohol may be made under the premises licence-

- a) at a time where there is no designated premises supervisor in respect of the premises licence, or
- b) at a time when the designated premises supervisor does not hold a personal licence or his personal licence is suspended

1.

- (1) The responsible person must ensure that staff on relevant premises do not carry out, arrange or participate in any irresponsible promotions in relation to the premises
- (2) In this paragraph, an irresponsible promotion means any one or more of the following activities, or substantially similar activities, carried on for the purpose of encouraging the sale or supply of alcohol for consumption on the premises;
  - (a) games or other activities which require or encourage, or are designed to require or encourage, individuals to—
    - (i) drink a quantity of alcohol within a time limit (other than to drink alcohol sold or supplied on the premises before the cessation of the period in which the responsible person is authorised to sell or supply alcohol), or
    - (ii) drink as much alcohol as possible (whether within a time limit or otherwise);
  - (b) provision of unlimited or unspecified quantities of alcohol free or for a fixed or discounted fee to the public or to a group defined by a particular characteristic in a manner which carries a significant risk of undermining a licensing objective
  - (c) provision of free or discounted alcohol or any other thing as a prize to encourage or reward the purchase and consumption of alcohol over a period of 24 hours or less in a manner which carries a significant risk of undermining a licensing objective;
  - (d) selling or supplying alcohol in association with promotional posters or flyers on, or in the vicinity of, the premises which can reasonably be considered to condone, encourage or glamorise anti-social behaviour or to refer to the effects of drunkenness in any favourable manner;
  - (e) dispensing alcohol directly by one person into the mouth of another (other than where that other person is unable to drink without assistance by reason of disability)

- 2. The responsible person must ensure that free potable water is provided on request to customers where it is reasonably available.

3.
  - (1) The premises licence holder or club premises certificate holder must ensure that an age verification policy is adopted in respect of the premises in relation to the sale or supply of alcohol.
  - (2) The designated premises supervisor in relation to the premises licence must ensure that the supply of alcohol at the premises is carried on in accordance with the age verification policy
  - (3) The policy must require individuals who appear to the responsible person to be under 18 years of age (or such older age as may be specified in the policy) to produce on request, before being served alcohol, identification bearing their photograph, date of birth and either—
    - (a) a holographic mark, or
    - (b) an ultraviolet feature.
  
4. The responsible person must ensure that—
  - (a) where any of the following alcoholic drinks is sold or supplied for consumption on the premises (other than alcoholic drinks sold or supplied having been made up in advance ready for sale or supply in a securely closed container) it is available to customers in the following measures—
    - (i) beer or cider: ½ pint
    - (ii) gin, rum, vodka or whisky: 25 ml or 35 ml; and
    - (iii) still wine in a glass: 125 ml;
  - (b) these measures are displayed in a menu, price list or other printed material which is available to customers on the premises; and
  - (c) where a customer does not in relation to a sale of alcohol specify the quantity of alcohol to be sold, the customer is made aware that these measures are available.
  
5.
  1. A relevant person shall ensure that no alcohol is sold or supplied for consumption on or off the premises for a price which is less than the permitted price.
  
  2. For the purposes of the condition set out in paragraph 1—
    - (a) “duty” is to be construed in accordance with the Alcoholic Liquor Duties Act 1979;
    - (b) “permitted price” is the price found by applying the formula —
 
$$P = D + (D \times V)$$
 where —
      - (i) **P** is the permitted price
      - (ii) **D** is the amount of duty chargeable in relation to the alcohol as if the duty were charged on the date of the sale or supply of the alcohol, and

- (iii) **V** is the rate of value added tax chargeable in relation to the alcohol as if the value added tax were charged on the date of the sale or supply of the alcohol;
  - (c) “relevant person” means, in relation to premises in respect of which there is in force a premises licence
    - (i) the holder of the premises licence
    - (ii) the designated premises supervisor (if any) in respect of such a licence, or
    - (iii) the personal licence holder who makes or authorises a supply of alcohol under such a licence
  - (d) “relevant person” means, in relation to premises in respect of which there is in force a club premises certificate, any member or officer of the club present on the premises in a capacity which enables the member or officer to prevent the supply in question; and
  - (e) “value added tax” means value added tax charged in accordance with the Value Added Tax Act 1994
3. Where the permitted price given by Paragraph (b) of paragraph 2 would (apart from this paragraph) not be a whole number of pennies, the price given by that sub-paragraph shall be taken to be the price actually given by that sub-paragraph rounded up to the nearest penny.
4. (1) Sub-paragraph (2) applies where the permitted price given by Paragraph (b) of paragraph 2 on a day (“the first day”) would be different from the permitted price on the next day (“the second day”) as a result of a change to the rate of duty or value added tax
- (2) The permitted price which would apply on the first day applies to sales or supplies of alcohol which take place before the expiry of the period of 14 days beginning on the second day

Where a premises licence includes a condition that at specified times one or more individuals must be at the premises to carry out a security activity, such individuals must be licensed with the Security Industry Authority. This does not apply to premises within paragraph. 8(3)(a) of Schedule 2 to the Private Security Industry Act 2001, (premises with premises licences authorising plays or films), or in respect of premises in relation to- any occasion mentioned in paragraph 8(3)(b) or (c) of Schedule 2 (premises being used exclusively by club with club premises certificate, under a temporary event notice authorising plays or films or under a gaming licence), or any occasion within paragraph 8(3)(d) of Schedule 2 (occasions prescribed by regulations under that Act) unless the Licence specifically states otherwise.

Security activity means an activity to which paragraph 2(1)(a) of Schedule 2 of the Private Security Industry Act 2001 of that schedule applies, and



Paragraph 8(5) of Schedule 2 (interpreting of references to an occasion) applies as it applies in relation to paragraph 8 of Schedule 2 of the Private Security Industry Act 2001

Where the exhibition of films is authorised, the admission of children to the exhibition of any film must be to be restricted as follows: If the London Borough of Tower Hamlets Licensing Section has issued a particular notification of restriction to the licence holder, that restriction must be adhered. Otherwise the recommendation of the film classification body must be followed. Children means persons aged under 18 and “film classification body” means the person or persons designated as the authority under section 4 of the Video Recordings Act 1984 (currently the British Board of Film Classification)

## **Annex 2 - Conditions consistent with the operating Schedule**

1. CCTV. The CCTV system shall incorporate a recording facility and any recordings shall be retained and stored in a suitable and secure manner for a minimum of 31 days. A system shall be in place to maintain the quality of the recorded image and a complete audit trail maintained. The system will comply with other essential legislation, and all signs as required will be clearly displayed. The system will be maintained and fully operational throughout the hours that the premises are open for any licensable activity. There must also be someone on the premises, who can download the images and present them on request by a police officer or other responsible authority. One camera be placed outside the entrance and on entry;
2. Use of Incident/refusal book;
3. The external area will be closed by 22:30hrs each day;
4. Security staff will be employed at busier times;
5. The premises will ensure appropriately times deliveries to minimise local disruption;
6. The outside trading area will be monitored for noise;
7. The premises will have notices for customers to consider locals;
8. The premises will ensure strict adherence to age requirements for the serving of alcohol;
9. The premises will be proactive in their liaison with local residents.

**Annex 3 - Conditions attached after a hearing by the licensing authority**

Not applicable

**Annex 4 - Plans**

The plans are those submitted to the licensing authority on the following date:

10<sup>th</sup> November 2015 – Licensing Plan (543 – 01.02.01)

**Part B - Premises licence summary**

**Premises licence number**

19857

**Premises details**

**Postal address of premises, or if none, ordnance survey map reference or description**

(Grand Union Company Ltd.)  
Units 1, 2 and 3  
Thomas More Square

**Post town**

London

**Post code**

E1W 1YN

**Telephone number**

None

Where the licence is time limited the dates

Not applicable

Licensable activities authorised by the licence

- The sale by retail of alcohol
- The provision of late night refreshment
- The provision of regulated entertainment

The times the licence authorises the carrying out of licensable activities

The supply of alcohol (both on and off sales)

- Monday to Wednesday from 11:00hrs to 00:00hrs (midnight)
- Thursday to Saturday from 11:00hrs to 01:00hrs (the following day)
- Sunday from 11:00hrs to 22:00hrs

The provision of late night refreshment (both indoors and outdoors)

- Monday to Saturday from 23:00hrs to 00:00hrs (midnight)

The provision of regulated entertainment in the form of live music (indoors)

- Monday to Saturday from 19:00hrs to 23:00hrs
- Sunday from 13:00hrs to 22:00hrs

The provision of regulated entertainment in the form of recorded music (indoors)

- Monday to Wednesday from 07:00hrs to 00:00hrs (midnight)
- Thursday to Saturday from 07:00hrs to 01:00hrs (the following day)

The provision of regulated entertainment in the form of films (indoors)

- Monday to Saturday from 09:30hrs to 23:00hrs
- Sunday from 09:30hrs to 22:00hrs

The opening hours of the premises

- Monday to Wednesday from 07:00hrs to 00:00hrs (midnight)
- Thursday to Saturday from 07:00hrs to 01:30hrs (the following day)
- Sunday 07:00hrs to 22:00hrs

Name, (registered) address of holder of premises licence

Grand Union Company Ltd.  
111 Kennington Road  
London, SE11 6SF

Where the licence authorises supplies of alcohol

On and off sales

Registered company number

06671807

Name of designated premises supervisor

John Byrne

State whether access to the premises by children is restricted or prohibited

No restrictions

# Appendix 2



This form should be completed and forwarded to: Licensing Section, Mulberry Place (AH), PO Box 55739, 5 Clove Crescent, London E14 1BY with a cheque for the correct fee, made payable to the London Borough of Tower Hamlets.

[http://www.towerhamlets.gov.uk/content\\_pages/pay\\_it.aspx](http://www.towerhamlets.gov.uk/content_pages/pay_it.aspx)

Or alternatively from <http://www.towerhamlets.gov.uk/> under 'Online Services'

**Application to vary a premises licence under the Licensing Act 2003**

**PLEASE READ THE FOLLOWING INSTRUCTIONS FIRST**

Before completing this form please read the guidance notes at the end of the form. If you are completing this form by hand please write legibly in block capitals. In all cases ensure that your answers are inside the boxes and written in black ink. Use additional sheets if necessary. You may wish to keep a copy of the completed form for your records.

**We** GRAND UNION COMPANY LTD. (Insert name(s) of applicant)

Being the premises licence holder, apply to vary a premises licence under section 34 of the Licensing Act 2003 for the premises described in Part 1 below.

Premises Licence number 19857

**Part 1 – Premises details**

Postal address of premises or, if none, ordnance survey map reference or description <u>TRADE UNION</u> <u>3 THOMAS MORE SQUARE</u>	
Post town <u>LONDON</u>	Post code <u>E1W 1YW</u>

Telephone number at premises (if any)

[Redacted]

Non-domestic rateable value of premises

£ 90'500

## Part 2 - Applicant details

Daytime contact telephone number			
E-mail address (optional)			
Current postal address if different from premises address			
Post Town		Postcode	

## Part 3 - Variation

Do you want the proposed variation to have effect as soon as possible? Please tick yes

If not, when do you want the variation to take effect from?

Day	Month	Year

Please describe briefly the nature of the proposed variation (please see guidance note1)

EXTENSION OF TRADING HOURS UNTIL 3AM ON SATURDAY NIGHT/SUNDAY MORNING.

If your proposed variation would mean that 5,000 or more people are expected to attend the premises at any one time, please state the number expected to attend

--

## Part 4 Operating Schedule

Please complete those parts of the Operating Schedule below which would be subject to change if this application to vary is successful.

### Provision of regulated entertainment

- Please tick  if yes
- a) plays (if ticking yes, fill in box A)
  - b) films (if ticking yes, fill in box B)
  - c) indoor sporting events (if ticking yes, fill in box C)
  - d) boxing or wrestling entertainment (if ticking yes, fill in box D)
  - e) live music (if ticking yes, fill in box E)
  - f) recorded music (if ticking yes, fill in box F)
  - g) performances of dance (if ticking yes, fill in box G)
  - h) anything of a similar description to that falling within (e), (f) or (g)  
(if ticking yes, fill in box H)

---

Provision of late night refreshment (if ticking yes, fill in box I)



Supply of alcohol (if ticking yes, fill in box J)



In all cases complete boxes K, L and M



**A**

<b>Plays</b> Standard days and timings (please read guidance note 6)			<b>Will the performance of a play take place indoors or outdoors or both - please tick (please read guidance note 2)</b>	Indoors	
Day	Start	Finish		Outdoors	
				Both	
Mon			<b>Please give further details here (please read guidance note 3)</b>		
Tue					
Wed			<b>State any seasonal variations for performing plays (please read guidance note 4)</b>		
Thur					
Fri			<b>Non standard timings. Where you intend to use the premises for performance of plays at different times to those listed in the column on the left, please list (please read guidance note 5)</b>		
Sat					
Sun					

**B**

<b>Films</b> Standard days and timings (please read guidance note 6)			<b>Will the exhibition of a film take place indoors or outdoors or both - please tick (please read guidance note 2)</b>	Indoors	
Day	Start	Finish		Outdoors	
				Both	
Mon			<b>Please give further details here (please read guidance note 3)</b>		
Tue					
Wed			<b>State any seasonal variations for exhibition of films (please read guidance note 4)</b>		
Thur					
Fri			<b>Non standard timings. Where you intend to use the premises for exhibition of films at different times to those listed in the column on the left, please list (please read guidance note 5)</b>		
Sat					
Sun					

**C**

<b>Indoor sporting events</b> Standard days and timings (please read guidance note 6)			<p><b>Please give further details here</b> (please read guidance note 3)</p>  <p><b>State any seasonal variations for indoor sporting events</b> (please read guidance note 4)</p>  <p><b>Non standard timings. Where you intend to use the premises for indoor sporting events at different times to those listed in the column on the left, please list</b> (please read guidance note 5)</p>
Day	Start	Finish	
Mon			
Tue			
Wed			
Thur			
Fri			
Sat			
Sun			

**D**

<b>Boxing or wrestling entertainment</b> Standard days and timings (please read guidance note 6)			<p><b>Will the Boxing or wrestling entertainment take place indoors or outdoors or both - please tick</b> (please read guidance note 2)</p>	Indoors	
Day	Start	Finish		Outdoors	
				Both	
Mon			<b>Please give further details here</b> (please read guidance note 3)		
Tue					
Wed			<b>State any seasonal variations for boxing or wrestling entertainment</b> (please read guidance note 4)		
Thur					
Fri			<b>Non standard timings. Where you intend to use the premises for boxing or wrestling entertainment at different times to those listed in the column on the left, please list</b> (please read guidance note 5)		
Sat					
Sun					

**E**

Live music Standard days and timings (please read guidance note 6)			Will the performance of live music take place indoors or outdoors or both – please tick [Y] (please read guidance note 2)	Indoors		
Day	Start	Finish		Outdoors		
				Both		
Mon			<b>Please give further details here</b> (please read guidance note 3)			
Tue						
Wed				<b>State any seasonal variations for the performance of live music</b> (please read guidance note 4)		
Thur						
Fri				<b>Non standard timings. Where you intend to use the premises for the performance of live music at different times to those listed in the column on the left, please list</b> (please read guidance note 5)		
Sat						
Sun						

**F**

Recorded music Standard days and timings (please read guidance note 6)			Will the playing of recorded music take place indoors or outdoors or both – please tick [Y] (please read guidance note 2)	Indoors	<input checked="" type="checkbox"/>	
Day	Start	Finish		Outdoors		
				Both		
Mon	07:00	00:00	<b>Please give further details here</b> (please read guidance note 3)			
Tue	07:00	00:00				
Wed	07:00	00:00		<b>State any seasonal variations for playing recorded music</b> (please read guidance note 4)		
Thur	07:00	01:00				
Fri	07:00	01:00		<b>Non standard timings. Where you intend to use the premises for the playing of recorded music entertainment at different times to those listed in the column on the left, please list</b> (please read guidance note 5)		
Sat	07:00	03:00				
Sun	07:00	00:00				

**G**

Performances of dance Standard days and timings (please read guidance note 6)			Will the performance of dance take place indoors or outdoors or both – please tick [Y] (please read guidance note 2)	Indoors	
Day	Start	Finish		Outdoors	
Mon					
Tue			<b>Please give further details here</b> (please read guidance note 3)		
Wed					
Thur			<b>State any seasonal variations for the performance of dance</b> (please read guidance note 4)		
Fri					
Sat			<b>Non standard timings. Where you intend to use the premises for the performance of dance entertainment at different times to those listed in the column on the left, please list</b> (please read guidance note 5) 5)		
Sun					

**H**

Anything of a similar description to that falling within (e), (f) or (g) Standard days and timings (please read guidance note 6)			Please give a description of the type of entertainment you will be providing
Day	Start	Finish	
Mon			
Tue			
Wed			<b>State any seasonal variations for entertainment of a similar description to that falling within (e), (f) or (g)</b> (please read guidance note 4)
Thur			
Fri			<b>Non standard timings. Where you intend to use the premises for the entertainment of similar description to that falling within (e), (f) or (g) at different times to those listed in the column on the left, please list</b> (please read guidance note 5)
Sat			
Sun			

<b>Late night refreshment</b> Standard days and timings (please read guidance note 6)			<b>Will the provision of late night refreshment take place indoors or outdoors or both – please tick [Y] (please read guidance note 2)</b>	Indoors	<input checked="" type="checkbox"/>
Day	Start	Finish		Outdoors	<input checked="" type="checkbox"/>
Mon	23:00	00:00	<b>Please give further details here (please read guidance</b>	Both	<input type="checkbox"/>
Tue	23:00	00:00			
Wed	23:00	00:00	<b>State any seasonal variations for the provision of late night refreshment (please read guidance note 4)</b>		
Thur	23:00	01:00			
Fri	23:00	01:00	<b>Non standard timings. Where you intend to use the premises for the provision of late night refreshment at different times to those listed in the column on the left, please list (please read guidance note 5)</b>		
Sat	23:00	03:00			
Sun					

**J**

<b>Supply of alcohol</b> Standard days and timings (please read guidance note 6)			<b>Will the supply of alcohol be for consumption – please tick [Y] (please read guidance note 7)</b>	On the premises	<input checked="" type="checkbox"/>
Day	Start	Finish		Off the premises	<input checked="" type="checkbox"/>
Mon	11:00	00:00	<b>Please give further details here (please read guidance</b>	Both	<input checked="" type="checkbox"/>
Tue	11:00	00:00			
Wed	11:00	00:00	<b>State any seasonal variations for the supply of alcohol (please read guidance note 4)</b>		
Thur	11:00	01:00			
Fri	11:00	01:00	<b>Non standard timings. Where you intend to use the premises for the supply of alcohol at different times to those listed in the column on the left, please list (please read guidance note 5)</b>		
Sat	11:00	03:00			
Sun	11:00	22:00			

K

**Please highlight any adult entertainment or services, activities, other entertainment or matters ancillary to the use of the premises that may give rise to concern in respect of children (please read guidance note 8)**

N/A

L

Hours premises are open to the public Standard timings (please read guidance note 6)			State any seasonal variation (please read guidance note 4)
Day	Start	Finish	
Mon	07:00	00:00	Non standard timings. Where you intend to the premises to be open at different times to those listed in the column on the left, please list (please read guidance note 5)
Tue	07:00	00:00	
Wed	07:00	00:00	
Thur	07:00	01:30	
Fri	07:00	01:30	
Sat	07:00	03:00	
Sun	07:00	22:00	

Please identify those conditions currently imposed on the licence which you believe could be removed as a consequence of the proposed variation you are seeking

N/A

Please tick yes

- I have enclosed the premises licence
- I have enclosed the relevant part of the premises licence

If you have not ticked on of those boxes please fill in reasons for not including the licence, or part it below

Reasons why I have failed to enclose the premises licence or relevant part of premises licence
--



**M**

Describe any additional steps you intend to take to promote the four licensing objectives as a result of the proposed variation.

**a) General – all four licensing objectives (b,c,d,e) (please read guidance note 9)**

**b) The prevention of crime and disorder**

**c) Public safety**

**d) The prevention of public nuisance**

**e) The protection of children from harm**

**CHECKLIST:**

- Please tick  yes
- I have made or enclosed payment of the fee
  - I have sent copies of this application and the plan (showing the area to be licensed) to responsible authorities and others where applicable
  - I understand that I must now advertise my application
  - I have enclosed the premises licence or relevant part of it or explanation
  - I understand that if I do not comply with the above requirements my application will be rejected

**IT IS AN OFFENCE, LIABLE ON CONVICTION TO A FINE UP TO LEVEL 5 ON THE STANDARD SCALE, UNDER SECTION 158 OF THE LICENSING ACT 2003, TO MAKE A FALSE STATEMENT IN OR IN CONNECTION WITH THIS APPLICATION**

**Part 5 – Signatures** (please read guidance note 10)

Signature of applicant or applicant (the current premises licence holder) or applicant's solicitor or other duly authorised agent (please read guidance note 11). If signing on behalf of the applicant please state in what capacity.

Signature	[REDACTED]
Date	08/12/2016
Capacity	OPERATIONS MANAGER

Where the premises licence is jointly held signature of 2<sup>nd</sup> applicant (the current premises licence holder) or 2<sup>nd</sup> applicant's solicitor or other authorised agent (please read guidance note 12). If signing on behalf of the applicant please state in what capacity.

Signature	
Date	
Capacity	

Contact name (where not previously given) and postal address for correspondence associated with this application (please read guidance note 13)	
Post town	Post code
Telephone number (if any)	
If you would prefer us to correspond with you by e-mail your e-mail address (optional)	



### **Thomas More Square**

#### **Customer Management Strategy for trading until 03.00 on Saturdays.**

In addition to our overall customer management strategy we will implement specific measures after 23.00.

After 23:00 hours on Saturdays customers will only be permitted to leave the venue via the north-east exit onto Vaughan Way, 'Exit C' shown on drawing 4969 M 1001 PL Rev 8.

Appropriate management of this policy will be achieved through the following steps:

1. Erection of barriers, of the type identified in the attached Appendices. These barriers will be situated in the following locations;
  - a. 2 barriers to the left of our entrance, covering entrance into the square, this will minimise any noise reflection from the high glass buildings.
  - b. A further 2 or 3 barriers to the right of our entrance, preventing customers from going right onto Vaughan way.
  - c. We believe that this level of barrier coverage will be adequate to direct customers along the stipulated exit route towards East Smithfield. If additional barriers prove to be necessary, we will introduce adequate numbers to achieve the required customer movement.
2. A minimum of 5 SIA badged Door Supervisors to be working after 23:00 on Saturdays when trading until 03:00
3. A taxi rank to be managed at the top end of Vaughan way, with the junction of East Smithfield, to reduce any disruption to local residents.
4. At least one member of security will be stationed at the exit to our premises after 23.00, with the express task of directing customers immediately on exit toward the main exit route. The route which will have been defined through the positioning of our barriers, as noted in point 1. above.
5. Signs to be posted on all barriers reminding customers of local residents and asking them to minimise any noise.
6. All staff and external security personnel will be trained to an appropriate standard regarding the customer management strategy and their responsibilities under it.
7. We will implement external and internal signage to ensure that the message to customers is reinforced, regarding exit routes and consideration for local residents.



# Appendix 3

PROJECT NO. 543		DATE 01.02.01	
DATE 09/11/12	BY A.S.	DATE 09/11/12	BY A.S.
LICENSING PLAN			

1 Thomas More Square  
E1W 1YW

ADAM MARSHALL  
London  
111 Kensington Road  
E11 6P  
**KAI**  
18 Mansour Terrace  
London E16 7L  
K A Taylor Design  
28 300 London

Notes: All dimensions must be checked on site and verified with the contractor.

NO.	DESCRIPTION	REV.	DATE
1			

**TENDER**

[Symbol] Area covered by Smoke Ejectors  
 [Symbol] Area covered by Smoke Suction  
 [Symbol] Glass Doors and Windows  
 [Symbol] Fire Door - 20 min protection  
 [Symbol] Escaped Area

MEZANINE 1 of 2



GROUND 1 of 2

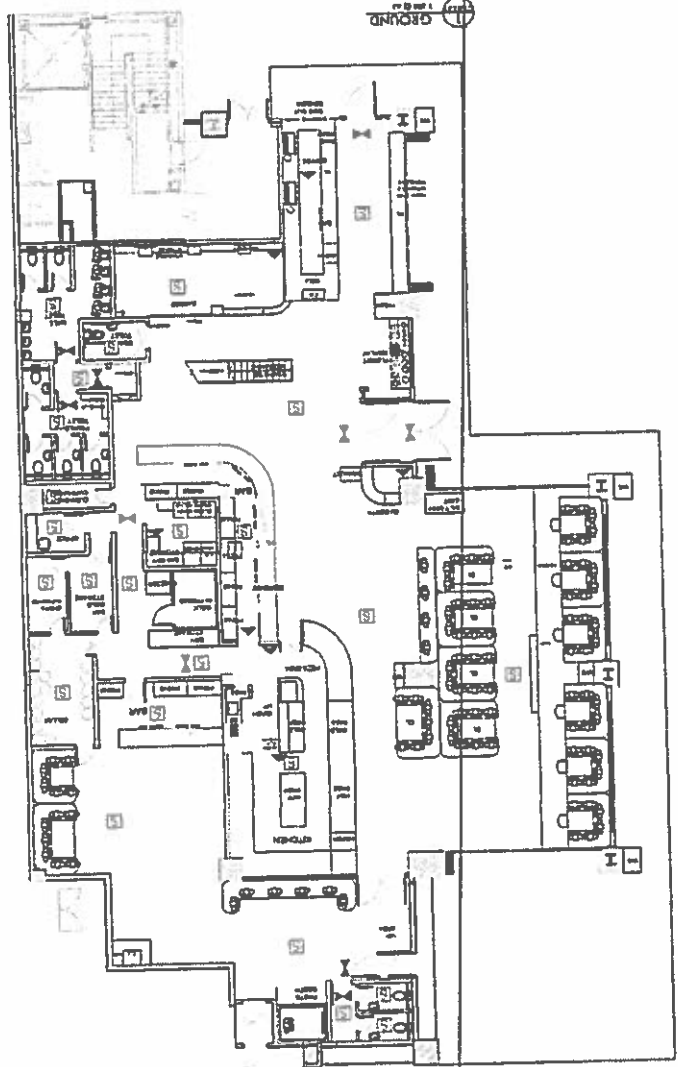

Notes:

# Appendix 4



# 3 Thomas More Square



Scale 1:1537

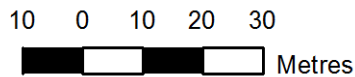



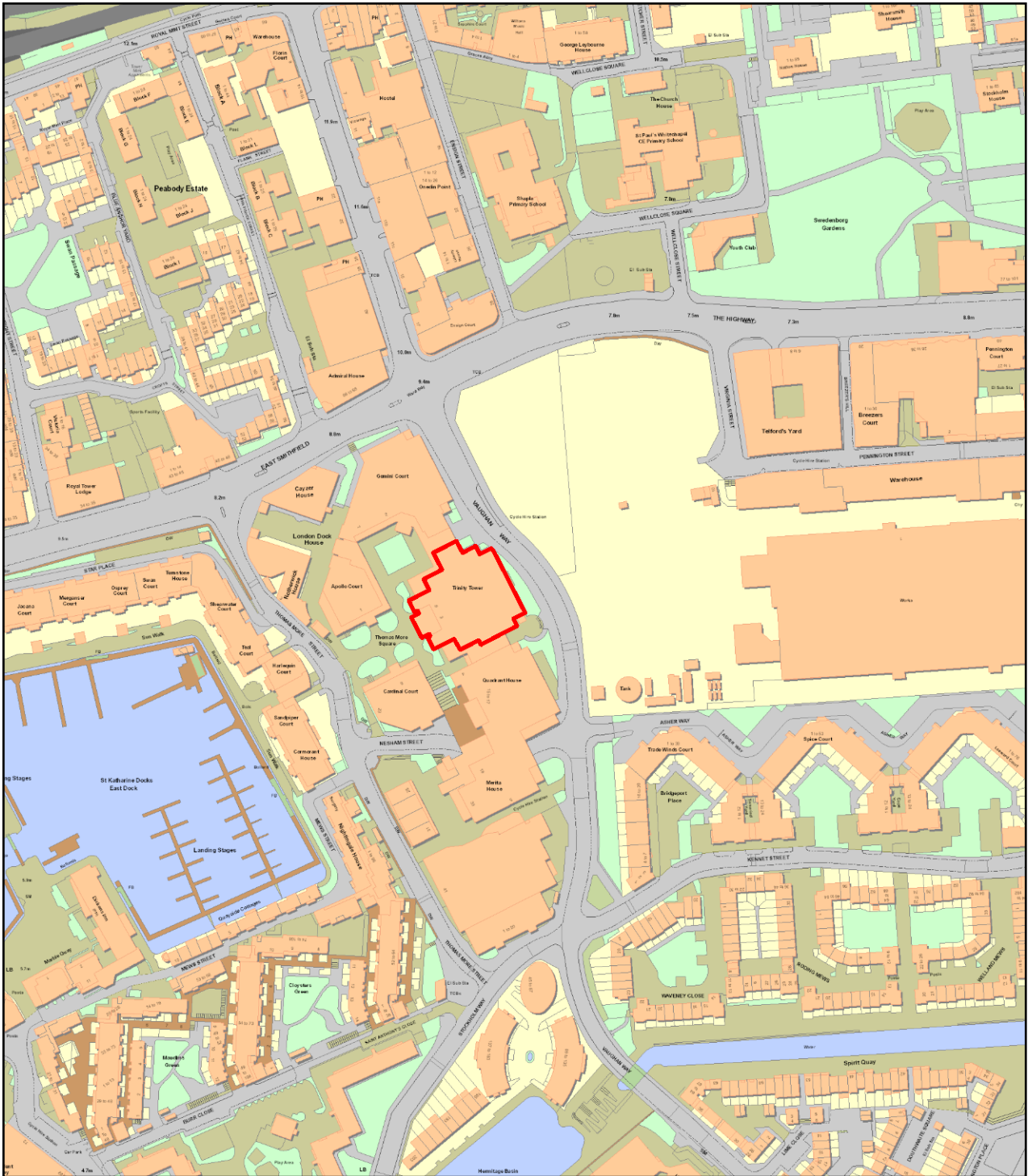

# 3 Thomas More Square



Scale 1:3074

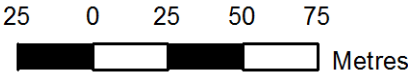

# Appendix 5

Nearest licensed premises: (Grand Union), 3 Thomas More Square

Name and address	Licensable hours	Opening hours
<p><b>(Churchills)</b>  <b>6 Thomas More Square</b>  <b>Wapping</b>  <b>London</b>  <b>E1W 1YY</b></p>	<p>Alcohol (on and off sales) shall not be sold or supplied except during permitted hours.            In this condition, permitted hours means:            a. On weekdays, other than Christmas Day, Good Friday or New Year's Eve, 10 a.m. to 11 p.m.            b. On Sundays, other than Christmas Day or New Year's Eve, 12 noon to 10.30 p.m.            c. On Good Friday, 12 noon to 10.30 p.m.            d. On Christmas Day, 12 noon to 3 p.m. and 7 p.m. to 10.30 p.m.            e. On New Year's Eve, except on a Sunday, 11 a.m. to 11 p.m.            f. On New Year's Eve on a Sunday, 12 noon to 10.30 p.m.            g. On New Year's Eve from the end of permitted hours to the start of permitted hours on the following day (or, if there are no permitted hours on the following day, midnight on 31st December).</p> <p>For conditions re. "drinking up time" see Annex 1 Mandatory Conditions</p> <p>Note: However, New Years Eve is subject to the Regulatory Reform (Special Occasion Licensing) Order 2002. Which means that while that order is in effect the premises may remain open for the twelve hours between 11pm on New Years Eve and 11am on New Years Day.</p>	<p>No restriction on hours</p>
<p><b>(Pumblechook's Deli Cafe)</b>  <b>27-29 Thomas More Street</b>  <b>London</b>  <b>E1W 1YW</b></p>	<p><u>The Supply of Alcohol (both on and off premises)</u></p> <ul style="list-style-type: none"> <li>• Monday to Saturday from 11:00hrs to 21:00hrs</li> <li>• Sunday from 11:00hrs 15:00hrs</li> </ul>	<p>Monday to Friday from 06:30hrs to 21:00hrs            Saturday from 08:00hrs to 21:00hrs            Sunday from 09:00hrs to 15:00hrs</p>
<p><b>(Chuzzlewits)</b>  <b>Ground Floor,</b>  <b>21 Thomas More Street</b>  <b>London</b>  <b>E1W 1YY</b></p>	<p>Alcohol shall not be sold or supplied except during permitted hours.            In this condition, permitted hours means:            a. On weekdays, other than Christmas Day, Good Friday or New Year's Eve, 10 a.m. to 11 p.m.            b. On Sundays, other than Christmas Day or New Year's Eve, 12 noon to 10.30 p.m.            c. On Good Friday, 12 noon to 10.30 p.m.</p>	<p>No restriction on hours</p>

	<p>d. On Christmas Day, 12 noon to 3 p.m. and 7 p.m. to 10.30 p.m.</p> <p>e. On New Year's Eve, except on a Sunday, 11 a.m. to 11 p.m.</p> <p>f. On New Year's Eve on a Sunday, 12 noon to 10.30 p.m.</p> <p>g. On New Year's Eve from the end of permitted hours to the start of permitted hours on the following day (or, if there are no permitted hours on the following day, midnight on 31st December).</p> <p>For conditions re. "drinking up time" see Annex 1 Mandatory Conditions</p> <p>Note: However, New Years Eve is subject to the Regulatory Reform (Special Occasion Licensing) Order 2002. Which means that while that order is in effect the premises may remain open for the twelve hours between 11pm on New Years Eve and 11am on New Years Day.</p>	
<p><b>(Corney and Barrow)</b>  <b>1 Thomas More Street</b>  <b>London</b>  <b>E1W 1YZ</b></p>	<p>Monday to Sunday from 08:00 hours to 23:00 hours</p> <p>Note: However, New Years Eve is subject to the Regulatory Reform (Special Occasion Licensing) Order 2002. Which means that while that order is in effect the premises may remain open for the twelve hours between 11pm on New Years Eve and 11am on New Years Day.</p>	<p>Monday to Sunday from 08:00 hours to 23:00 hours</p> <p>Note: However, New Years Eve is subject to the Regulatory Reform (Special Occasion Licensing) Order 2002. Which means that while that order is in effect the premises may remain open for the twelve hours between 11pm on New Years Eve and 11am on New Years Day.</p>
<p><b>(Waitrose)</b>  <b>41 Thomas More Street</b>  <b>St Katharine Docks</b>  <b>London</b>  <b>E1W 1YY</b></p>	<p>Monday to Sunday from 07:00 hours to 23:00 hours</p>	<p>Monday to Sunday from 07:00 hours to 23:00 hours</p>

# Appendix 6

## Mohshin Ali

---

**From:** [REDACTED]@police.uk  
**Sent:** 26 February 2017 20:11  
**To:** Mohshin Ali  
**Cc:** Nicola Cadzow  
**Subject:** Trade Union, 3 Thomas More Sq, E1

Dear Licensing.

On Thursday 12th January 2017 , Nicola Cadzow of LBTH EH and I met the applicants to discuss the variation. At the time we agreed the following:

All licensable activities : Saturday : until 0130 (Sun)  
Closing at 0200

Even at the time, I had concerns that the hours agreed may have been too long. However I received an email from Adam Marshall, the Chief Executive for Trade Union to ask me to reconsider the hours. We also talked on the telephone and I would say there was some disagreement on the proposed hours.

I have been quoted that the Urban Bar in Whitechapel Road has a 3am licence and a half drinking up time. This may well be the case but it was granted in 2005 and if they were to apply today, Tower Hamlets Police Licensing Unit would be opposing such a late hour.

There are certainly a number of bars that have late hours but equally there are probably more that have lesser hours.

If the Trade Union was to obtain their full variation I believe it will undermine the licensing objectives of the prevention of crime and disorder and the prevention of public nuisance.

There are a number of new residential buildings close to Trade Union. At 2-3am , noise can certainly travel whether it is just people talking excitedly or waiting for taxis.

I have visited the bar and it was laid out with a large number of tables to attract a food lead customer base. However on visiting on the 25th February 2017 at about 2215 to conduct a visit with my LFB colleagues and LBTH Licensing, the majority of tables had been removed , a DJ set up, turning the bar into what looked like a night club.

They had a TEN for the evening and at that time only a handful of customers. SIA staff were on duty. It would appear therefore that this is more of a late night attraction /club than the relaxed atmosphere of the early evening.

The applicant has been applying for TENs and there has been no early morning incidents. However there is a difference between running the occasional event and one every weekend. Small incidents can sometimes lead to disorder.

There has been one reported incident at Trade Union. On Friday 10th February 2017 at about 2045. At this time the suspect had been drinking at the bar and was heavily intoxicated. A member of the door staff asked him to leave. He initially left but soon returned and was refused entry by the door staff. This resulted in the suspect attacking the door staff. The suspect knocked over a standing heater and then picked up a bucket, hitting the window, cracking the glass. The suspect was detained by the door staff and arrested on police arrival. This was captured on CCTV and downloaded at a later time.

3am would certainly be the longest hours granted for a bar that I can remember for some years. If the committee are to consider granting the variation I would ask that they do not exceed 2am. Residential properties will bear the brunt of such late hours.

Alan Cruickshank PC 189HT

**Total Policing is the Met's commitment to be on the streets and in your communities to catch offenders, prevent crime and support victims. We are here for London, working with you to make our capital safer.**

## Mohshin Ali

---

**From:** [REDACTED].police.uk  
**Sent:** 03 February 2017 14:11  
**To:** Mohshin Ali; Nicola Cadzow; [REDACTED]@grandunionbars.c[REDACTED]; [REDACTED]@grandunionbars.c[REDACTED]  
**Cc:** [REDACTED]; [REDACTED]@grandunionbars[REDACTED]  
**Subject:** Trade Union Licence Variation Application

Hi Mohshin

I have been unable to contact Mr Marshall but will try again. In the mean time, I wish to object to this application on the licensing objectives of the prevention of crime and disorder and the prevention of public nuisance.

I believe a 3am finish would at the very least cause a noise nuisance from people leaving the bar at 3am and standing about in the street waiting for taxis etc.

If we cannot reach an agreement, I will expand on my objection at a later time.

Regards

Alan Cruickshank PC 189HT

---

**From:** Mohshin Ali [REDACTED]  
**Sent:** 03 February 2017 12:17  
**To:** Nicola Cadzow; Cruickshank Alan D - HT; [REDACTED]@grandunionbars[REDACTED]; [REDACTED]@grandunionbars[REDACTED]  
**Cc:** [REDACTED]; [REDACTED]@grandunionbars[REDACTED]; HT - Licensing Office  
**Subject:** RE: Trade Union Licence Variation Application

Dear All,

As the consultation period ends today (3<sup>rd</sup> February 2017), please let me know the outcome before midnight.

Thanks

### *Mohshin Ali - Senior Licensing Officer*

Licensing Team . Environmental Health & Trading Standards . John Onslow House . 1 Ewart Place . London E3 5EQ

 [REDACTED] |  [REDACTED] |  [REDACTED]

 [Licensing@towerhamlets.gov.uk](mailto:Licensing@towerhamlets.gov.uk)



---

**From:** Nicola Cadzow  
**Sent:** 03 February 2017 08:48  
**To:** [REDACTED].police.uk; [REDACTED]@grandunionbars[REDACTED]; [REDACTED]@grandunionbars[REDACTED]; Mohshin Ali  
**Cc:** Martin [REDACTED]; [REDACTED]@grandunionbars[REDACTED]; [REDACTED].police.uk  
**Subject:** RE: Trade Union Licence Variation Application

Dear Adam,

Each premises is looked at individually, and as Alan has said I am also happy to attend a licensing committee hearing.

Kind regards

Nicola Cadzow  
Environmental Health Technical Officer  
Place Directorate  
Public Realm - Environmental Health and Trading Standards  
London Borough of Tower Hamlets 5 Clove Crescent London, E14 2BG

---

**From:** [REDACTED].police.uk [mailto:[REDACTED].police.uk]  
**Sent:** 03 February 2017 08:39  
**To:** [REDACTED]@grandunionbars.[REDACTED]grandunionbars.com; Mohshin Ali; Nicola Cadzow  
**Cc:** [REDACTED]; [REDACTED]@grandunionbars.[REDACTED].police.uk  
**Subject:** Trade Union Licence Variation Application

Dear Adam

I have come late into this conversation. Are you now withdrawing our agreement?

There are many bars that have shorter hours with a few that have longer hours. I am happy to attend a licensing committee to explain my reasons.

Best wishes

Alan

---

**From:** Adam Marshall [mailto:[REDACTED]@grandunionbars.[REDACTED]]  
**Sent:** 02 February 2017 15:41  
**To:** Perry MARK J - HT; Mark Whitmore; [REDACTED]towerhamlets.gov.uk;  
[REDACTED]towerhamlets.gov.uk; Cruickshank Alan D - HT  
**Cc:** [REDACTED]; John Byrne; HT - Licensing Office  
**Subject:** Re: Trade Union Licence Variation Application

**Without prejudice**

Dear Mark,

Thank you for your note.

The bar referenced is Urban Bar in Whitechapel <http://www.theurbanbar.co.uk> which has a 3am license with 30 mins drinking up time every Friday and Saturday evening/Sunday morning.

I would be grateful if you could call me tomorrow morning to discuss further.

Many thanks and Kind regards

Adam

Adam Marshall  
Chief Executive



**GRAND UNION / TRADE UNION**

[REDACTED]  
[REDACTED]

---

[REDACTED] "[\[REDACTED\]@towerhamlets.gov.uk](mailto:[REDACTED]@towerhamlets.gov.uk)" [REDACTED] "[\[REDACTED\]@towerhamlets.gov.uk](mailto:[REDACTED]@towerhamlets.gov.uk)"  
**Date:** Thursday, 2 February 2017 at 14:07  
**To:** Mark Whitmore <[\[REDACTED\]@grandunionbars.com](mailto:[REDACTED]@grandunionbars.com)>, [REDACTED] "[\[REDACTED\]@towerhamlets.gov.uk](mailto:[REDACTED]@towerhamlets.gov.uk)"  
[REDACTED] "[\[REDACTED\]@towerhamlets.gov.uk](mailto:[REDACTED]@towerhamlets.gov.uk)"  
[REDACTED] "[\[REDACTED\]@towerhamlets.gov.uk](mailto:[REDACTED]@towerhamlets.gov.uk)">, [REDACTED] "[\[REDACTED\]@towerhamlets.gov.uk](mailto:[REDACTED]@towerhamlets.gov.uk)"  
[REDACTED] "[\[REDACTED\]@towerhamlets.gov.uk](mailto:[REDACTED]@towerhamlets.gov.uk)">  
**Cc:** "[REDACTED]" <[\[REDACTED\]@grandunionbars.com](mailto:[REDACTED]@grandunionbars.com)>, [REDACTED] "[\[REDACTED\]@grandunionbars.com](mailto:[REDACTED]@grandunionbars.com)">, [REDACTED] "[\[REDACTED\]@met.police.uk](mailto:[REDACTED]@met.police.uk)"  
**Subject:** RE: Trade Union Licence Variation Application

Dear all,

As far as I am aware the Urban Bar Three Colts Street has a license till 01:30 not 3:00am.

Regards

Mark

PC Mark Perry  
Police Licensing Officer  
Toby Club  
Vawdry Close  
E1 9UA

---

**From:** Mark Whitmore [REDACTED]  
**Sent:** 02 February 2017 13:57  
**To:** Mohshin Ali; Nicola Cadzow; Cruickshank Alan D - HT  
**Cc:** [REDACTED] Adam Marshall; John Byrne; HT - Licensing Office  
**Subject:** RE: Trade Union Licence Variation Application

Mr Ali,

**Without prejudice**

Thank you very much for coming back to me so quickly.

We were advised in our licensing meeting by Ms Cadzow that 1am was currently the latest licence in the Borough, and that by granting us the 2am we would become the latest licence. Since then we have discovered that we were misinformed as Urban Bar currently trades with a 3am licence.

We would like to be considered for the 3am variation on **Saturdays only** to bring us in line with other licensed premises in the Borough. As stated in my previous letter 2<sup>nd</sup> February, Trade Union/Grand Union is a very good and competent operator of London late night venues.

Please come back to me at your earliest convenience with any more information you may require.

Kind Regards

MARK WHITMORE  
Operations Manager

**GRAND UNION / TRADE UNION**

[REDACTED]  
[REDACTED]  
[REDACTED]

**From:** Mohshin Ali [redacted]  
**Sent:** 02 February 2017 13:06  
**To:** Mark Whitmore <[redacted]>; Nicola Cadzow <[redacted]>; [redacted]  
**Cc:** M [redacted] Adam Marshall <[redacted].com>; John Byrne <[redacted]>; [redacted] e [redacted] <[redacted]>  
**Subject:** RE: Trade Union Licence Variation Application

Dear All,

**Licensing Act 2003**

Variation: (Grand Union Company Ltd.), Units 1, 2 and 3, Thomas More Square, London E1W 1YN

Just to clarify, does that mean Alan's email of 12 January 2017 (attached) no longer applies?

Please note that the consultation period ends on the **3<sup>rd</sup> February 2017**.

Regards

**Mohshin Ali - Senior Licensing Officer**

Licensing Team . Environmental Health & Trading Standards. John Onslow House. 1 Ewart Place. London E3 5EQ

[redacted] [redacted] [redacted]  
[redacted]  
[Licensing@towerhamlets.gov.uk](mailto:Licensing@towerhamlets.gov.uk)



---

**From:** Mark Whitmore [redacted]  
**Sent:** 02 February 2017 12:44  
**To:** Nicola Cadzow; Mohshin Ali; [redacted]  
**Cc:** [redacted] Adam Marshall; John Byrne  
**Subject:** Trade Union Licence Variation Application

Nicola/ Alan,  
Please see attached letter regarding the licence variation application for Trade Union.  
Kind Regards

MARK WHITMORE  
Operations Manager  
**GRAND UNION / TRADE UNION**

[redacted]

\*\*\*\*\*  
\*\*\*\*\*

Working Together for a Better Tower Hamlets  
Web site : <http://www.towerhamlets.gov.uk>

London Borough of Tower Hamlets E-Mail Disclaimer.

This communication and any attachments are intended for the addressee only and may be confidential. It may contain privileged and confidential information and if you are not the intended recipient, you must not copy, distribute or take any action in reliance on it. If you have received this E-Mail in error please notify us as soon as possible and delete this E-Mail and any attachments. This message has been checked for viruses, however we cannot guarantee that this message or any attachment is virus free or has not been intercepted or amended. The information contained in this E-Mail may be subject to public disclosure under the Freedom of Information Act 2000. Unless the information is legally exempt from disclosure, the Confidentiality of this E-Mail and your reply cannot be guaranteed.

## Mohshin Ali

---

**From:** Alan.D.Cruickshank [REDACTED]  
**Sent:** 12 January 2017 14:23  
**To:** [REDACTED] Nicola Cadzow  
**Cc:** Licensing  
**Subject:** Trade Union, 3 Thomas Square, E1

**Follow Up Flag:** Follow up  
**Flag Status:** Completed

Dear Licensing

Having met with the applicants today , we have agreed the following:

All licensable activities : Saturday : until 0130 (Sun)  
Closing at 0200

Best wishes

Alan

**Total Policing is the Met's commitment to be on the streets and in your communities to catch offenders, prevent crime and support victims. We are here for London, working with you to make our capital safer.**

**Consider our environment - please do not print this email unless absolutely necessary.**

NOTICE - This email and any attachments may be confidential, subject to copyright and/or legal privilege and are intended solely for the use of the intended recipient. If you have received this email in error, please notify the sender and delete it from your system. To avoid incurring legal liabilities, you must not distribute or copy the information in this email without the permission of the sender. MPS communication systems are monitored to the extent permitted by law. Consequently, any email and/or attachments may be read by monitoring staff. Only specified personnel are authorised to conclude any binding agreement on behalf of the MPS by email. The MPS accepts no responsibility for unauthorised agreements reached with other employees or agents. The security of this email and any attachments cannot be guaranteed. Email messages are routinely scanned but malicious software infection and corruption of content can still occur during transmission over the Internet. Any views or opinions expressed in this communication are solely those of the author and do not necessarily represent those of the Metropolitan Police Service (MPS).

**Find us at:**

**Facebook:** [Facebook.com/metpoliceuk](https://www.facebook.com/metpoliceuk)

**Twitter:** [@metpoliceuk](https://twitter.com/metpoliceuk)

# Appendix 7

## Mohshin Ali

---

**From:** Nicola Cadzow  
**Sent:** 01 March 2017 08:42  
**To:** Mohshin Ali  
**Cc:** [REDACTED].police.uk'  
**Subject:** RE: Trade Union, 3 Thomas More Sq, E1

Dear Licensing

A site meeting was undertaken with the applicants on 12<sup>th</sup> January 2017 with Alan Cruickshank and myself regarding the variation application for the Premises License and the potential impact of public nuisance and measures to prevent noise generated from within the premises or outside it which could cause disturbance to people in the vicinity, the proposed hours are well beyond the Council's framework hours, and an agreement was made in respect to the variation of opening hours.

It must be noted that the Council's framework hours (i.e. when premises are open) are:

- **Monday to Thursday 0600 hours to 2330 hours; and**
- **Friday & Saturday 0600 hours to midnight**
- **Sunday 0600 hours to 2230 hours.**

The Premise Current Opening Hours are already beyond the Council's Framework hours:

- **Monday to Thursday 0700 hours to Midnight; and**
- **Friday & Saturday 0700 hours to 01:30 hours**
- **Sunday 0700 hours to 2200 hours.**

It was agreed with the applicant:

- **Saturday all Licensable Activities till 01:30 hours, with premises closing at 0200 hours**

The applicant is now insisting on

- **Saturday premises closing at 0300 hours**

**Noise Sensitive premises:** residential and commercial premises in close proximity to Trade Union 3 Thomas More Square, E1W 1YW at Teal Court 71 residential properties 37 Metres away, Sandpiper House 33 residential premise 43 Metres away, Harlequin Court 81 residential premises 23 metres away.

In my view the application, as it stands fails, to comply with the objective of the Licensing Act 2003 relating to "public nuisance" for the following reasons:-

- Access & egress to and from the venue, of patrons, especially due to patrons likely to be in high spirits; and
- The hours of operation (inclusive of proposals)

### **CONCLUSION**

Environmental Protection **does not** support the application for Trade Union 3 Thomas More Square, E1W 1YW as there is great likelihood of disturbance to residential premises at the noise sensitive hours sought of 0300 hours.

Kind regards

Nicola Cadzow

Environmental Health Technical Officer  
Place Directorate  
Public Realm - Environmental Health and Trading Standards  
London Borough of Tower Hamlets 5 Clove Crescent London, E14 2BG

---

**From:** [REDACTED]@police.uk [REDACTED]  
**Sent:** 26 February 2017 20:11  
**To:** Mohshin Ali  
**Cc:** Nicola Cadzow  
**Subject:** Trade Union, 3 Thomas More Sq, E1

Dear Licensing.

On Thursday 12th January 2017 , Nicola Cadzow of LBTH EH and I met the applicants to discuss the variation. At the time we agreed the following:

All licensable activities : Saturday : until 0130 (Sun)  
Closing at 0200

Even at the time, I had concerns that the hours agreed may have been too long. However I received an email from Adam Marshall, the Chief Executive for Trade Union to ask me to reconsider the hours. We also talked on the telephone and I would say there was some disagreement on the proposed hours.

I have been quoted that the Urban Bar in Whitechapel Road has a 3am licence and a half drinking up time. This may well be the case but it was granted in 2005 and if they were to apply today, Tower Hamlets Police Licensing Unit would be opposing such a late hour.

There are certainly a number of bars that have late hours but equally there are probably more that have lesser hours.

If the Trade Union was to obtain their full variation I believe it will undermine the licensing objectives of the prevention of crime and disorder and the prevention of public nuisance.

There are a number of new residential buildings close to Trade Union. At 2-3am , noise can certainly travel whether it is just people talking excitedly or waiting for taxis.

I have visited the bar and it was laid out with a large number of tables to attract a food lead customer base. However on visiting on the 25th February 2017 at about 2215 to conduct a visit with my LFB colleagues and LBTH Licensing, the majority of tables had been removed , a DJ set up, turning the bar into what looked like a night club.

They had a TEN for the evening and at that time only a handful of customers. SIA staff were on duty. It would appear therefore that this is more of a late night attraction /club than the relaxed atmosphere of the early evening.

The applicant has been applying for TENs and there has been no early morning incidents. However there is a difference between running the occasional event and one every weekend. Small incidents can sometimes lead to disorder.

There has been one reported incident at Trade Union. On Friday 10th February 2017 at about 2045. At this time the suspect had been drinking at the bar and was heavily intoxicated. A member of the door staff asked him to leave. He initially left but soon returned and was refused entry by the door staff. This resulted in the suspect attacking the door staff. The suspect knocked over a standing heater and then picked up a bucket, hitting the window, cracking the glass. The suspect was detained by the door staff and arrested on police arrival. This was captured on CCTV and downloaded at a later time.

3am would certainly be the longest hours granted for a bar that I can remember for some years. If the committee are to consider granting the variation I would ask that they do not exceed 2am. Residential properties will bear the brunt of such late hours.

Alan Cruickshank PC 189HT

## Mohshin Ali

---

**From:** Nicola Cadzow  
**Sent:** 03 February 2017 14:58  
**To:** 'A [REDACTED] Mohshin Ali; [REDACTED]  
[REDACTED]  
[REDACTED]  
**Subject:** RE: Trade Union Licence Variation Application

Hi Mohshin

We are unable to reach an agreement with the applicant with regards opening hours of 0300 hours, which in my view is too late due to access & egress to and from the venue, of patrons, especially due to patrons likely to be in high spirits and the hours of operation (inclusive of proposals).

Therefore please take this as my representation to the application, as I do not believe the licensing objective for the Prevention of Public Nuisance will be met at the hours sought.

I will provide a more details representation in due course.

Kind regards

Nicola Cadzow  
Environmental Health Technical Officer  
Place Directorate  
Public Realm - Environmental Health and Trading Standards  
London Borough of Tower Hamlets 5 Clove Crescent London, E14 2BG

---

**From:** Alan.D.Cruickshank [REDACTED]  
**Sent:** 03 February 2017 14:11  
**To:** Mohshin Ali; Nicola Cadzow; a [REDACTED]@grandunionbars. [REDACTED]@grandunionbars [REDACTED]  
**Cc:** [REDACTED]@grandunionbars. [REDACTED]  
**Subject:** Trade Union Licence Variation Application

Hi Mohshin

I have been unable to contact Mr Marshall but will try again. In the mean time, I wish to object to this application on the licensing objectives of the prevention of crime and disorder and the prevention of public nuisance.

I believe a 3am finish would at the very least cause a noise nuisance from people leaving the bar at 3am and standing about in the street waiting for taxis etc.

If we cannot reach an agreement, I will expand on my objection at a later time.

Regards

Alan Cruickshank PC 189HT

**From:** Mohshin Ali [REDACTED]  
**Sent:** 03 February 2017 12:17  
**To:** Nicola Cadzow; Cruickshank Alan D - HT; [REDACTED]@grandunionbars.com [REDACTED] [REDACTED]@grandunionbars.com [REDACTED]  
**Cc:** [REDACTED]@grandunionbars.com [REDACTED] HT - Licensing Office  
**Subject:** RE: Trade Union Licence Variation Application

Dear All,

As the consultation period ends today (3<sup>rd</sup> February 2017), please let me know the outcome before midnight.

Thanks

***Mohshin Ali - Senior Licensing Officer***

Licensing Team . Environmental Health & Trading Standards . John Onslow House . 1 Ewart Place . London E3 5EQ



[REDACTED] [REDACTED] [REDACTED] |

[Licensing@towerhamlets.gov.uk](mailto:Licensing@towerhamlets.gov.uk)



---

**From:** Nicola Cadzow  
**Sent:** 03 February 2017 08:48  
**To:** 'Alan.D.Cruickshank [REDACTED]@grandunionbars.com [REDACTED]@grandunionbars.com [REDACTED] Mohshin Ali  
**Cc:** [REDACTED]@grandunionbars.com [REDACTED]@met.police.uk  
**Subject:** RE: Trade Union Licence Variation Application

Dear Adam,

Each premises is looked at individually, and as Alan has said I am also happy to attend a licensing committee hearing.

Kind regards

Nicola Cadzow  
Environmental Health Technical Officer  
Place Directorate  
Public Realm - Environmental Health and Trading Standards  
London Borough of Tower Hamlets 5 Clove Crescent London, E14 2BG

---

**From:** [\[REDACTED\]@met.police.uk](mailto:[REDACTED]@met.police.uk) [REDACTED]  
**Sent:** 03 February 2017 08:39  
**To:** [REDACTED]@grandunionbars.com; [REDACTED]@grandunionbars.com; Mohshin Ali; Nicola Cadzow  
**Cc:** [REDACTED]@met.police.uk  
**Subject:** Trade Union Licence Variation Application

Dear Adam

I have come late into this conversation. Are you now withdrawing our agreement?



There are many bars that have shorter hours with a few that have longer hours. I am happy to attend a licensing committee to explain my reasons.

Best wishes

Alan

---

**From:** Adam Marshall [REDACTED]  
**Sent:** 02 February 2017 15:41  
**To:** Perry MARK J - HT; Mark Whitmore; [Mohshin.Ali](#) [REDACTED]  
[Nicola.Cadzow](#) [REDACTED]; Cruickshank Alan D - HT  
**Cc:** [REDACTED] John Byrne; HT - Licensing Office  
**Subject:** Re: Trade Union Licence Variation Application

**Without prejudice**

Dear Mark,

Thank you for your note.

The bar referenced is Urban Bar in Whitechapel <http://www.theurbanbar.co.uk> which has a 3am license with 30 mins drinking up time every Friday and Saturday evening/Sunday morning.

I would be grateful if you could call me tomorrow morning to discuss further.

Many thanks and Kind regards

Adam

Adam Marshall  
Chief Executive  
**GRAND UNION / TRADE UNION**

[REDACTED]  
[REDACTED] | [REDACTED]

---

**From:** [REDACTED] [met.pnn.police.uk](mailto:met.pnn.police.uk)" [REDACTED] [met.pnn.police.uk](mailto:met.pnn.police.uk)>  
**Date:** Thursday, 2 February 2017 at 14:07  
**To:** Mark Whitmore <[REDACTED]> "[Mohshin.Ali](#)" [REDACTED]  
<[Mohshin.Ali@towerhamlets.gov.uk](mailto:Mohshin.Ali@towerhamlets.gov.uk)>, "[Nicola.Cadzow](#)" [REDACTED]  
<[Nicola.Cadzow](#) [REDACTED], "[Alan.D.Cruickshank](#)" [REDACTED]  
<[Alan.D.Cruickshank@](#) [REDACTED]  
**Cc:** "[REDACTED] Adam Marshall  
[REDACTED]" [REDACTED]  
[REDACTED]  
**Subject:** RE: Trade Union Licence Variation Application

Dear all,

As far as I am aware the Urban Bar Three Colts Street has a license till 01:30 not 3:00am.

Regards

Mark

PC Mark Perry  
Police Licensing Officer  
Toby Club  
Vawdry Close  
E1 9UA

---

**From:** Mark Whitmore [REDACTED]  
**Sent:** 02 February 2017 13:57  
**To:** Mohshin Ali; Nicola Cadzow; Cruickshank Alan D - HT  
**Cc:** [REDACTED] Adam Marshall; John Byrne; HT - Licensing Office  
**Subject:** RE: Trade Union Licence Variation Application

Mr Ali,

**Without prejudice**

Thank you very much for coming back to me so quickly.

We were advised in our licensing meeting by Ms Cadzow that 1am was currently the latest licence in the Borough, and that by granting us the 2am we would become the latest licence. Since then we have discovered that we were misinformed as Urban Bar currently trades with a 3am licence.

We would like to be considered for the 3am variation on **Saturdays only** to bring us in line with other licensed premises in the Borough. As stated in my previous letter 2<sup>nd</sup> February, Trade Union/Grand Union is a very good and competent operator of London late night venues.

Please come back to me at your earliest convenience with any more information you may require.

Kind Regards

MARK WHITMORE

Operations Manager

[REDACTED]

[REDACTED]

[REDACTED]

<image004.png>

---

**From:** Mohshin Ali [REDACTED]  
**Sent:** 02 February 2017 13:06  
**To:** Mark Whitmore [REDACTED]; Nicola Cadzow  
<[REDACTED]>  
**Cc:** [REDACTED] John Byrne  
[REDACTED] <[REDACTED]>  
[REDACTED]

**Subject:** RE: Trade Union Licence Variation Application

Dear All,

**Licensing Act 2003**

Variation: (Grand Union Company Ltd.), Units 1, 2 and 3, Thomas More Square, London E1W 1YN

Just to clarify, does that mean Alan's email of 12 January 2017 (attached) no longer applies?

Please note that the consultation period ends on the **3<sup>rd</sup> February 2017**.

Regards

**Mohshin Ali - Senior Licensing Officer**

Licensing Team . Environmental Health & Trading Standards. John Onslow House. 1 Ewart Place. London E3 5EQ

[REDACTED]

[REDACTED]



**From:** Mark Whitmore [REDACTED]  
**Sent:** 02 February 2017 12:44  
**To:** Nicola Cadzow; Mohshin Ali; [REDACTED]  
**Cc:** [REDACTED] Adam Marshall; John Byrne  
**Subject:** Trade Union Licence Variation Application  
Nicola/ Alan,  
Please see attached letter regarding the licence variation application for Trade Union.  
Kind Regards  
MARK WHITMORE  
Operations Manager  
**GRAND UNION / TRADE UNION**  
[REDACTED] 6SF  
[REDACTED]

\*\*\*\*\*  
\*\*\*\*\*

Working Together for a Better Tower Hamlets  
Web site : <http://www.towerhamlets.gov.uk>

London Borough of Tower Hamlets E-Mail Disclaimer.

This communication and any attachments are intended for the addressee only and may be confidential. It may contain privileged and confidential information and if you are not the intended recipient, you must not copy, distribute or take any action in reliance on it. If you have received this E-Mail in error please notify us as soon as possible and delete this E-Mail and any attachments. This message has been checked for viruses, however we cannot guarantee that this message or any attachment is virus free or has not been intercepted or amended. The information contained in this E-Mail may be subject to public disclosure under the Freedom of Information Act 2000. Unless the information is legally exempt from disclosure, the Confidentiality of this E-Mail and your reply cannot be guaranteed.

If your request relates to a Freedom of Information enquiry, please resend this to [foi@towerhamlets.gov.uk](mailto:foi@towerhamlets.gov.uk)  
\*\*\*\*\*  
\*\*\*\*\*

Please consider your environmental responsibility: Before printing this e-mail or any other document , ask yourself whether you need a hard copy.

**Total Policing is the Met's commitment to be on the streets and in your communities to catch offenders, prevent crime and support victims. We are here for London, working with you to make our capital safer.**

**Consider our environment - please do not print this email unless absolutely necessary.**

NOTICE - This email and any attachments may be confidential, subject to copyright and/or legal privilege and are intended solely for the use of the intended recipient. If you have received this email in error, please notify the sender and delete it from your system. To avoid incurring legal liabilities, you must not distribute or copy the information in this email without the permission of the sender. MPS communication systems are monitored to the extent permitted by law. Consequently, any email and/or attachments may be read by monitoring staff. Only specified personnel are authorised to conclude any binding agreement on behalf of the MPS by email. The MPS accepts no responsibility for unauthorised agreements reached with other employees or agents. The security of this email and any attachments cannot be guaranteed. Email messages are routinely scanned but malicious software infection and corruption of content can still occur during transmission over the Internet. Any

# Appendix 8

## Mohshin Ali

---

**From:** Mark Whitmore <[REDACTED]>  
**Sent:** 02 February 2017 12:44  
**To:** Nicola Cadzow; Mohshin Ali; Alan.D.Cruickshank [REDACTED]  
**Cc:** [REDACTED]; Adam Marshall; John Byrne  
**Subject:** Trade Union Licence Variation Application  
**Attachments:** Trade Union Licence Variation Application.docx; Whitechapel Road 176.pdf

**Follow Up Flag:** Follow up  
**Flag Status:** Flagged

Nicola/ Alan,

Please see attached letter regarding the licence variation application for Trade Union.

Kind Regards

MARK WHITMORE  
Operations Manager

**GRAND UNION / TRADE UNION**  
[REDACTED]  
[REDACTED]

# GRAND UNION

Grand Union Company Limited  
111 Kennington Road  
London  
SE11 6SF  
24/01/2017

## **Without Prejudice**

### **RE: Trade Union Wapping Licence Variation**

Dear Nicola,

Thank you very much for your time at our recent meeting, we found it very useful.

During our meeting on 12th January 2017 to discuss our application for a variation to the licence at Trade Union Wapping, 3 Thomas More Square, London, E1W 1YW, we were made aware that you were not content with our original application to supply alcohol until 03am on Saturday nights / Sunday mornings, and that you would be happy to grant a 2am licence, which would bring us in line with the latest trading licence in the Tower Hamlets Borough.

Since our conversation, I have been made aware that Urban Bar, 176 Whitechapel Road, E1 1BJ has a licence to supply alcohol until 3am on both Friday and Saturday Nights (Copy of licence attached).

We feel this sets a precedent that Tower Hamlets Council could grant 3am licences and that we should be allowed the same opportunity as other businesses trading in the area.

Grand Union Company Limited is looking to vary the licence until 3am on Saturday night / Sunday morning only.

As a significant contributor of business rates to the Tower Hamlets Borough I'm sure you can appreciate our need to run a profitable business, and a 3am licence will assist with this.

Trade Union is a business that has traded until 3am previously using Temporary Event Notices, we have a proven track record as a responsible operator. As discussed, we have also put together a Management Plan to ensure that any disruption is minimised or eliminated.

The Management Plan that we presented to you includes:

- Door Supervisors for late-night trading
- Barriers for managing customer flow
- Active Dispersal Management Procedures
- A Designated Taxi Company

We have a very good relationship with business' as well as local residents and will work to ensure this continues. Our aim is to provide local residents with what they are looking for in terms of a later night experience, often choosing to go out later in the evening (10pm/11pm), wanting to come home later.

#### **Grand Union Head Office**

111 Kennington Road | London SE11 6SF | t: 020 7226 3303 | [www.grandunionbars.com](http://www.grandunionbars.com)

Registered Company: Grand Union Company Limited | Company Number: 06671807

# GRAND UNION

As a company trading for 11 years in the London late night sector we are an operator of many late night licenses in various London Boroughs, including Islington, Lambeth, Wandsworth, Camden and City of London.

We would welcome another conversation on this matter or a meeting in a view to Tower Hamlets issuing our license as requested.

Please contact me directly if you require any further information.

Many thanks and kind regards.

Mark Whitmore

Operations Manager

Grand Union Company Limited

**Grand Union Head Office**

111 Kennington Road | London SE11 6SF | t: 020 7226 3303 | [www.grandunionbars.com](http://www.grandunionbars.com)

Registered Company: Grand Union Company Limited | Company Number: 06671807

**Postal Address  
(LHT-URBAN BAR)  
176 Whitechapel Road  
London  
E1 1BJ**

**Licensable Activities authorised by the licence**

**The sale by retail of alcohol  
Regulated Entertainment  
Late Night Refreshment**

**See the attached licence for the licence conditions**

**Signed by**

**John Cruse \_\_\_\_\_  
Team Leader Licensing**

**Date: 11<sup>th</sup> November 2005**



**Part A - Format of premises licence**

Premises licence number

10196

**Part 1 - Premises details****Postal address of premises, or if none, ordnance survey map reference or description****(LHT-URBAN BAR)  
176 Whitechapel Road****Post town****London****Post code****E1 1BJ****Telephone number****Where the licence is time limited the dates**

Not applicable

**Licensable activities authorised by the licence**The sale by retail of alcohol  
Regulated Entertainment  
Late Night Refreshment**The times the licence authorises the carrying out of licensable activities****For the Supply of Alcohol and Late Night Refreshment**Sunday to Thursday 07 00 hrs to 02 00 hrs the following day  
Friday and Saturday 07 00 hrs until 03 00 hrs the following day**Recorded Music (including facilities)**Sunday to Thursday 07 00 hrs to 02 00 hrs the following day  
Friday and Saturday 07 00 hrs until 03 00 hrs the following day**Live Music (including facilities), Dancing and Provision of Facilities for Dancing**Sunday to Thursday 18 00 hrs to 02 00 hrs the following day  
Friday and Saturday 18 00 hrs until 03 00 hrs the following day

**For all regulated activities**

Note: However, New Years Eve is subject to the Regulatory Reform (Special Occasion Licensing) Order 2002. Which means that while that order is in effect the premises may remain open for the twelve hours between 11pm on New Years Eve and 11am on New Years Day.

**The opening hours of the premises**

Monday to Sunday 07 00 hrs to 04 00 hrs the following day

**Where the licence authorises supplies of alcohol whether these are on and/ or off supplies**

On and off sales

## **Part 2**

**Name, (registered) address, telephone number and email (where relevant) of holder of premises licence**

[REDACTED]

**Registered number of holder, for example company number, charity number (where applicable)**

**Name, address and telephone number of designated premises supervisor where the premises licence authorises the supply of alcohol**

[REDACTED]

**Personal licence number and issuing authority of personal licence held by designated premises supervisor where the premises licence authorises for the supply of alcohol**

[REDACTED]

### **Annex 1 - Mandatory conditions**

No supply of alcohol may be made under the premises licence-

- a) at a time where there is no designated premises supervisor in respect of the premises licence, or

- b) at a time when the designated premises supervisor does not hold a personal licence or his personal licence is suspended

Every supply of alcohol under the premises licence must be made or authorised by a person who holds a personal licence

### **Door Supervisors**

Where a premises licence includes a condition that at specified times one or more individuals must be at the premises to carry out a security activity, such individuals must be licensed with the Security Industry Authority.

This does not apply to premises within paragraph 8(3)(a) of Schedule 2 to the Private Security Industry Act 2001, (premises with premises licences authorising plays or films), or

in respect of premises in relation to-

any occasion mentioned in paragraph 8(3)(b) or (c) of Schedule 2 (premises being used exclusively by club with club premises certificate, under a temporary event notice authorising plays or films or under a gaming licence), or

any occasion within paragraph 8(3)(d) of Schedule 2 (occasions prescribed by regulations under that Act) unless the Licence specifically states otherwise.

Security activity means an activity to which paragraph 2(1)(a) of Schedule 2 of the Private Security Industry Act 2001 of that schedule applies, and Paragraph 8(5) of Schedule 2 (interpreting of references to an occasion) applies as it applies in relation to paragraph 8 of Schedule 2 of the Private Security Industry Act 2001

### **Annex 2 - Conditions consistent with the operating Schedule**

The beer cellar and storage area in the basement are not accessible to the public

The second floor is private and not accessible to the public

At all times the premises are open to the public a personal licence holder will be present

Vertical drinking will be discouraged by seating

Opened glass containers will not be allowed to leave the premises. Anyone drinking or wishing to leave with glass containers outside the premises will be provided with a plastic cup

The immediate neighbours will be given a contact number for the Designated Premises Supervisor

Litter will be cleared away from the immediate area

All exits to have a notice asking customers to leave quietly

Exterior doors to have notices advising of the age policy

During live music performance all exterior doors will be kept closed

Under 18s are only admitted before 18 00 hrs, except for a private function

An appointed mini-cab firm will be used, and the firm will be required to enter the premises, not sound a horn

### **Regulated Entertainment**

**This is subject to the following conditions:**

Only live music, recorded music, dance and the provision of facilities for making music and dancing are permitted

No adult entertainment

The rules of the Council relating to the management of places of public entertainment must be met

The maximum number of persons to be accommodated at any one time shall not exceed 100 persons in the ground floor bar and 80 in the first floor room

The doors to Whitechapel Road shall be unlocked to permit exit at all times that either areas are open for use

Two Door Supervisors registered with the London Borough of Tower Hamlets shall be employed whenever the public entertainment licence is in use

All amplified equipment shall be connected through to the noise limiter which should be active and set at 94 dB Leq lin; 91dBA as agreed with the Environmental Health Department (Environment Protection) in order to control noise levels

All noise emanating from the premise must not cause a statutory nuisance as set out in Section 79, Sub-Section (1) paragraph (g) of the Environmental Protection Act 1990 within any other premise.

**Annex 3 - Conditions attached after a hearing by the licensing authority**

No drinking to be allowed in the street outside the premises

**Annex 4 - Plans**

The plans are those submitted to the licensing authority on the following date:

18 July 2005



Part B - Premises licence summary

Premises licence number

10196

Premises details

Postal address of premises, or if none, ordnance survey map reference or description  
**(LHT-URBAN BAR)**  
176 Whitechapel Road  
E1 1BJ

Post town  
London

Post code  
E1 1BJ

Telephone number  
[REDACTED]

Where the licence is time limited the dates

N/a

Licensable activities authorised by the licence

The sale of retail of alcohol  
Regulated Entertainment  
Late Night Refreshment

The times the licence authorises the carrying out of licensable activities

**For the Supply of Alcohol and Late Night Refreshment**  
Sunday to Thursday 07 00 hrs to 02 00 hrs the following day  
Friday and Saturday 07 00 hrs until 03 00 hrs the following day

**Recorded Music (including facilities)**  
Sunday to Thursday 07 00 hrs to 02 00 hrs the following

day  
Friday and Saturday 07 00 hrs until 03 00 hrs the following day

**Live Music (including facilities), Dancing and Provision of Facilities for Dancing**

Sunday to Thursday 18 00 hrs to 02 00 hrs the following day

Friday and Saturday 18 00 hrs until 03 00 hrs the following day

**For all regulated activities**

Note: However, New Years Eve is subject to the Regulatory Reform (Special Occasion Licensing) Order 2002. Which means that while that order is in effect the premises may remain open for the twelve hours between 11pm on New Years Eve and 11am on New Years Day.

The opening hours of the premises

Monday to Sunday 07 00 hrs to 04 00 hrs the following day

Name, (registered) address of holder of premises licence

[Redacted]

Where the licence authorises supplies of alcohol whether these are on and / or off supplies

On and off

Registered number of holder, for example company number, charity number (where applicable)

[Redacted]

Name of designated premises supervisor where the premises licence authorises for the supply of alcohol

[Redacted]

State whether access to the premises by children is restricted or prohibited

No

# Appendix 9



## **Noise while the premise is in use**

### General Advice

If they conclude this is a problem Members should consider whether it is possible to carry out suitable and proportionate noise control measures so that noise leakage is prevented. In addition Members may consider that only certain activities are suitable.

The hours of operation also need to be considered (see below).

If Members believe that there is a substantial problem of noise while the premises are in use and it cannot be proportionately address by licensing conditions they should refuse the application.

### Licensing Policy

The policy recognises that noise nuisance can be an issue, especially if a premises is open late at night. **(See Sections 8.1 of the Licensing Policy)**.

While all applications will be considered on their merits, consideration will be given to imposing stricter conditions in respect of noise control where premises are situated close to local residents. **(See Section 12.11)**.

The Licensing Authority expects the applicant to have addressed all nuisance issues relating to the premises in their operating schedule and to have sought appropriate advice from the Council's Environmental Health Officers. **(See Section 8.2 of the Licensing Policy)**.

The Licensing Authority will consider attaching conditions to prevent nuisance and these may include Conditions drawn from the Model Poll of Conditions relating to Crime and Disorder. **(See Appendix 2 Annex D of the Licensing Policy)**. In particular Members may wish to consider (this list is not exhaustive):

- hours of opening (this needs to be balanced against potential disorder caused by artificially early closing times)
- Whether certain parts should close earlier than the rest (for example a "beer garden", or restricted in their use)
- Whether or not certain activities should have to close at an early hour, for example live music
- Conditions controlling noise or vibration (for example, noise limiters, keeping doors and windows closed).
- Prominent clear and legible notices at all exits requesting the public to respect the needs of local residents and leave the premises and area quietly
- Conditions controlling the use of explosives, pyrotechnics and fireworks
- Conditions controlling the placing of refuse
- Conditions controlling noxious smells

- Conditions controlling lighting (this needs to be balanced against potential crime prevention benefits)

### Police Powers

Part 8 of the Licensing Act 2003 enables a senior police officer to close down a premises for up to 24 hrs. a premises causing a nuisance resulting from noise emanating from the premises.

### Guidance Issued under Section 182 of the Licensing Act 2003

The Licensing Policy has adopted the recommended Pool of Conditions as permitted (13.20 and Annex D).

The prevention of public nuisance could include low-level nuisance, perhaps affecting a few people living locally as well as major disturbance affecting the whole community (2.33).

Licence conditions should not duplicate other legislation (1.16).

Necessary and appropriate conditions should normally focus on the most sensitive periods (2.36) and may address disturbance as customers enter or leave the premises but it is essential that conditions are focused on measures within the direct control of the licence holder (2.38).

### Other Legislation

The Environmental Protection Act 1990, Part 111 gives Environmental Health Officers the power to deal with statutory nuisances.

The Anti-social Behaviour Act 2003, Sections 40 and 41 give Environmental Health Officers the power of closure up to 24 hours in certain circumstances.

# Appendix 10

## **Access and Egress Problems**

Such as:

Disturbance from patrons arriving/leaving the premises on foot

Disturbance from patrons arriving/leaving the premises by car

Lack of adequate car parking facilities

Close proximity to residential properties

### Comment

The above have been grouped together as egress problems. Of course the particular facts will be different for each alleged problem.

Egress only is referred to-if necessary access can be added or substituted in.

### General Advice

In considering concerns relating to disturbance from egress, Members need to be satisfied that the premises under consideration has been identified as the source of the actual or potential disturbance. If they are satisfied that this is a problem, then proportionate conditions should be considered.

The hours of operation also need to be considered.

If Members believe that there is a substantial problem concerning egress and it cannot be proportionately addressed by licensing conditions, they should refuse the application.

### Licensing Policy

The policy recognises that noise nuisance can be an issue, especially if a premises is open late at night. (**See Section 10 of the Licensing Policy**).

The Licensing Authority expects the applicant to have addressed all nuisance issues relating to the premises in their operating schedule and to have sought appropriate advice from the Council's Environmental Health Officers. (**See Section 10.2 of the Licensing Policy**).

The policy also recognises that staggered closing can help prevent problems at closure time (**See Section 15.1**).

However, while all applications will be considered on their merits, consideration will be given to imposing stricter conditions in respect of noise control where premises are situated close to local residents. (**See Section 15.5**)

The Council has adopted a set of framework hours (**See 15.8 of the licensing policy**). This relates to potential disturbance caused by late night trading.

The Licensing Authority will consider attaching conditions to prevent nuisance and these may include Conditions drawn from the Model Pool of Conditions relating to the prevention of Public Nuisance. (**See Annex G of the Licensing Policy**). In particular Members may wish to consider (this list is not exhaustive):

- hours of opening (this needs to be balanced against potential disorder caused by artificially early closing times)
- Whether certain parts should close earlier than the rest (for example a “beer garden”, or restricted in their use)
- Whether or not certain activities should have to close at an early hour, for example live music
- Conditions controlling noise or vibration (for example, noise limiters, keeping doors and windows closed).
- Prominent clear and legible notices at all exits requesting the public to respect the needs of local residents and leave the premises and area quietly

#### Guidance Issued under Section 182 of the Licensing Act 2003

The prevention of public nuisance could include low-level nuisance, perhaps affecting a few people living locally as well as major disturbance affecting the whole community. (2.19).

Licence conditions should not duplicate other legislation (1.16).

Any conditions should be tailored to the type, nature and characteristics of the specific premises. Licensing authorities should be aware of the need to avoid inappropriate or disproportionate measures that could deter events that are valuable to the community, such as live music. Noise limiters, for example, are very expensive to purchase and install and are likely to be a considerable burden for smaller venues. (2.20)

Measures can include ensuring the safe departure of customers, these can include:

- Providing information on the premises of local taxi companies who can provide safe transportation home; and
- Ensuring adequate lighting outside the premises, particularly on paths leading to and from the premises and in car parks

Necessary and appropriate conditions should normally focus on the most sensitive periods (2.22) and may address disturbance as customers enter or leave the premises but it is essential that conditions are focused on measures within the direct control of the licence holder.

# Appendix 11

## **Anti-Social Behaviour on the Premises**

### Licensing Policy

The Licensing Authority expects the applicant to have addressed all crime and disorder issues relating to the premises in their operating schedule and to have sought appropriate advice. (**See Section 6 of the Licensing Policy**)

The Licensing Authority will consider attaching conditions to deter crime and disorder and these may include conditions drawn from the Model Poll of Conditions relating to Crime and Disorder. (**See Appendix 3 of the Licensing Policy**). In particular Members may wish to consider (this list is not exhaustive):

- Methods of management communication
- Use of registered Door Supervisors
- Bottle Bans
- Plastic containers
- CCTV
- Restrictions on open containers for “off sales”
- Restrictions on drinking areas
- Capacity
- Proof of Age scheme
- Crime prevention notices
- Drinks promotions-aimed at stopping irresponsible promotions
- Signage
- Seating plans
- Capacity

If Members believe that there is a substantial problem of anti-social behaviour and it cannot be proportionately addressed by licensing conditions they should refuse the application.

### Police Powers

The Licensing Act 2003, Part 8 gives a senior police officer the power to close a premises for up to 24 hours where the officer believes there is, or is likely to be disorder on or in the vicinity and closure is necessary in the interests of public safety.

### Guidance Issued under Section 182 of the Licensing Act 2003

The pool of conditions, adopted by the Council is recommended (Annexe D).

The key role of the Police and SIA is acknowledged (2.1-2.2).

Conditions attached to licences cannot seek to manage the behaviour of customers once they are beyond the direct management of the licence holder and their staff or agents, but can directly impact on the behaviour of

Customers in the immediate vicinity of the premises as they seek entry or leave (1.16).

Conditions are best targeted on deterrence and preventing crime and disorder (2.3) communication, CCTV, police liaison, no glasses, capacity limits are all relevant (2.3 - 2.7).

#### Guidance Issued under Section 182 of the Licensing Act 2003

Conditions can be imposed for large capacity “vertical consumption” premises (10.23 – 10.24).

#### Guidance Issued by the Office of Fair Trading

This relates to attempts to control minimum prices.

#### Other Legislation

- The Council has a duty under Section 17 of the Crime and Disorder Act 1998 to do all it reasonably can to prevent crime and disorder.



# Appendix 12

## **Anti-Social Behaviour from Patrons Leaving the Premises**

### General Advice

Members need to bear in mind that once patrons have left a premises they are no longer under direct control. Members will need to be satisfied that there is a link between the way the premises is operating and the behaviour that is complained of. An example of this would be that irresponsible drinking is being encouraged. Before deciding that any particular licensing conditions are proportionate, Members will also need to be satisfied that other legislation is not a more effective route. For example, if the problem is drinking in the street it may be that the Council should designate the area as a place where alcohol cannot be consumed in public.

Members may also wish to consider whether the hours of opening relate to any problems of anti-social behaviour.

If Members believe that there is a substantial problem of anti-social behaviour and it cannot be proportionately addressed by licensing conditions they should refuse the application.

### Licensing Policy

The policy recognises that other legislation or measures may be more appropriate but also states that licensing laws are “a key aspect of such control and will always be part of an overall approach to the management of the evening and night time economy” (**see Section 4.15 and 4.16 of the Licensing Policy**).

The Licensing Authority expects the applicant to have addressed all crime and disorder issues relating to the premises in their operating schedule and to have sought appropriate advice. (**See Sections 6.2 of the Licensing Policy**)

The Licensing Authority will consider attaching conditions to deter crime and disorder and these may include Conditions drawn from the Model Poll of Conditions relating to Crime and Disorder. (**See Appendix 3 of the Licensing Policy**). In particular Members may wish to consider (this list is not exhaustive):

- Bottle Bans
- Plastic containers
- CCTV (outside the premises)
- Restrictions on open containers for “off sales”
- Proof of Age scheme
- Crime prevention notices
- Drinks promotions-aimed at stopping irresponsible promotions
- Signage

## Cumulative Impact

There is a process by which the Licensing Authority can determine that an area is saturated following representations. However, the process for this involves wide consultation and cannot come from representations about a particular application. (**See Section 7 of the Licensing Policy**).

## Police Powers

The Licensing Act 2003, Part 8 gives a senior police officer the power to close a premises for up to 24 hours where the officer believes there is, or is likely to be disorder on or in the vicinity and closure is necessary in the interests of public.

## Guidance Issued under Section 182 of the Licensing Act 2003

The key role of the Police is acknowledged (2.1).

Conditions attached to licences cannot seek to manage the behaviour of customers once they are beyond the direct management of the licence holder, but can relate to the immediate vicinity of the premises as they seek entry or leave (1.16).

Conditions are best targeted on deterrence and preventing crime and disorder (2.3) CCTV inside & out, communication, police liaison, no glasses are all relevant

There is also guidance issued around public nuisance (2.14 – 2.20).

The pool of conditions, adopted by the Council is recommended (see Appendix 3 of the Licensing Policy). Licence conditions should not duplicate other legislation (1.16).

Necessary and appropriate conditions should normally focus on the most sensitive periods and may address disturbance as customers enter or leave the premises but it is essential that conditions are focused on measures within the direct control of the licence holder (2.18/2.20).

Licensing law is not the primary mechanism for the general control of nuisance and anti-social behaviour by individuals once they are away from the licensed premises and, therefore, beyond the direct control of the individual, club or business holding the licence, certificate or authorisation concerned (13.13).

## Other Legislation

### Crime and Disorder Act 1998

The Council has a duty under Section 17 of the Crime and Disorder Act 1998 to do all it reasonably can to prevent crime and disorder.

The Act also introduced a wide range of measures designed to address anti-social behaviour committed by adults and young people. These include:

- Anti-Social Behaviour Orders
- Child Curfew Schemes
- Truancy
- Parenting Orders
- Reparation Orders
- Tackling Racism

# Appendix 13

## **Planning**

An application for a Premises Licence can be made in respect of a premises even where the premises does not have relevant Planning Permission. That application has to be considered and Members can only refuse the application where the application itself does not promote one of more of the Licensing Objectives. Members cannot refuse just because there is no planning permission. Where a Premises Licence is granted and which exceeds what is allowed by the Planning Permission and that Premises then operates in breach of planning then the operator would be liable to enforcement by Planning.

# Appendix 14

## **Licensing Policy Relating to Hours of Trading**

All applications have to be considered on their own merits.

The Council has however adopted a set of framework hours as follows:

- Monday to Thursday, from 06:00 hrs to 23:30 hrs
- Friday and Saturday, from 06:00 hrs to 00:00 hrs (midnight)
- Sunday, from 06:00 hrs to 22:30 hrs

(see 15.8 of the Licensing Policy)

In considering the applicability of frame work hours to any particular application regard should be had to the following

- Location
- Proposed hours of regulated activities, and the proposed hours the premises are open to the public
- The adequacy of the applicant's proposals to deal with issues of crime and disorder and public nuisance
- Previous history
- Access to public transport
- Proximity to other licensed premises, and their hours

(See 15.9 of the licensing policy)

Subject to any representations to the contrary in individual cases the following premises are not generally considered to contribute to late night anti-social behaviour and will therefore generally have greater freedom

- Theatres
- Cinemas
- Premises with club premises certificates